

DOCK BUMPERS

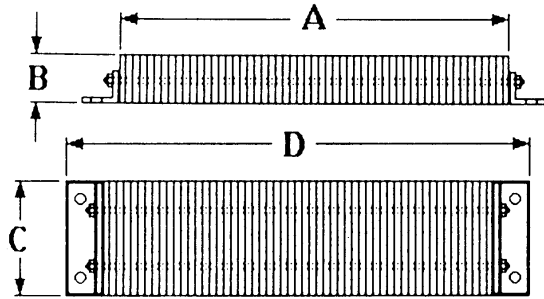

Laminated Rubber Bumpers Standard Bumper Sizes

Model No.	Rubber Face (A)	Rubber Projection (B)	Height (C)	Overall Width (D)	No. of Bolt Holes	Weight Lbs.
LB410-14	8"	4 1/2"	10"	14"	4	25
LB410-24	18"	4 1/2"	10"	24"	4	46
LB410-36	30"	4 1/2"	10"	36"	4	66
LVB420-14	8"	4 1/2"	20"	14"	6	47
LB510-14	8"	5 1/2"	10"	14"	4	29
LB510-24	18"	5 1/2"	10"	24"	4	52
LB510-36	30"	5 1/2"	10"	36"	4	89
LVB520-14	8"	5 1/2"	20"	14"	6	51

Material

Fabric reinforced rubber pads cut from recycled conveyor belting and tires. Rubber pads laminated between structural steel angles and secured with 3/4" steel tie rods.

Uses/applications

- Can be used in factories, warehouses, docks:
- For projecting above low docks
- Rub rails at the sides of truck wells
- Special construction features to accommodate unusual anchoring conditions (i.e.: flat plate on one side to weld to dock level curb angle).
- Wall bumpers to protect against fork lift trucks

Moulded Rubber Dock Bumpers

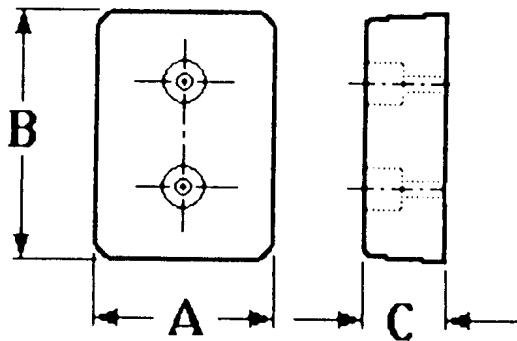

Standard Bumper Sizes

Model No.	Width A	Height B	Projection C	No of Bolt Holes	Weight Lbs
MB410	10"	13"	4"	2	18
MB418	10"	18"	4"	2	28
MB430	10"	30"	4"	3	42
MBL41818	18"	18"	4"	3	31
L-Shaped					

Uses/applications

- Perfect protection for high traffic truck docks
- In-plant wall protection from fork lifts and other material handling vehicles

Material/Thickness

- Manufactured from a blend of 95% recycled rubber
- Comes in four models - each with 4" projection
- All models have pre-drilled, countersunk mounting holes for easy installation and are drilled to accept 5/8" anchor bolts (not supplied)

Dock Bumper Accessories

Steel Extension Brackets

High strength steel brackets extend dock bumpers where greater "stand-out distance" from dock sills is required due to decline approach, canopied docks, overhangs or other architectural features.

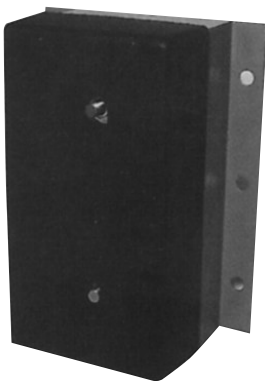

Above Dock Steel Brackets

An economical solution to below standard dock heights. Properly applied, these brackets will eliminate Truck-Dock Over-ride and extend the life of the dock bumpers. Recommended top of bumper mounting height is 48" - 52" off ground level.



Steel Bumper Caps

Over time, moulded bumpers will wear. This 5/16" steel bumper cap is designed to be installed over existing moulded bumpers with lag bolts thereby giving extra life to the units. This cap will also help against bumper damage caused by the up and down motion of trailers while being unloaded and air-ride trailer drop.

