

*Stretch Packaging Efficiency Redefined*



# Twenty years in the making, the Flex Series redefines stretch packaging technology

Twenty years and tens of thousands of machines later, Orion Packaging Systems has learned a thing or two about designing and building stretch wrapping machinery. The Flex Series brings together cutting edge technology and years of stretch wrapping experience to give you a line of turntable stretch wrappers that is unsurpassed in today's marketplace.



PLC Controller

- NEMA 12 Rated Control Box
- Operator Friendly Instructions
- Non-Proprietary Telemecanique PLC
- Includes Lanyard switch for remote start
- AC Motors with Variable Frequency Drives
- Large E-Stop / Cycle Pause Button
- Durable "no-wear" Lexan Surfaces
- Power Lockout Disconnect Switch



Control Panel HMI

No maze of confusing buttons and switches, just a clean, simple and easy to read HMI (Human Machine Interface) for fast and easy adjustments. A digital LCD display gives operator feedback on machine operating parameters.



Flex models use an industrial grade woven belt carriage lift for long service life and reliability. Orion's "drop lock" system prevents carriage movement in the unlikely event of belt breakage.



Orion Insta-Thread™ Film Delivery System

Film threading is fast, easy and safe thanks to simple "drop-in" film loading. Simply open the gate, drop the film tail in, and close the gate.



Graphic instructions on top of the carriage guide the operator through film threading.

## Flex machines are built rock solid

All Flex models are built from heavy gauge structural and formed steel to assure a long lasting, durable machine. For convenience, all machines are forklift portable from either the front or rear of the machine. Mounting tabs are provided for easy lagging to the floor if desired.



Orion Insta-Thread™ film carriage and film tail treatment mechanism on Flex LPA (top) and Flex HPA (bottom).

Flex A models eliminate the need for operators to attach and cut the stretch film. Simply place the pallet load on the machine, and pull a lanyard switch while backing away. The machine will perform the entire wrap cycle automatically without the need for an operator to tie the film tail to the load at the beginning of the cycle, and detach it at the end. This will greatly impact the efficiency of your stretch packaging operation by keeping your operators busy with other tasks while the machine is wrapping.

## *The Flex A (Automatic) Series is designed to save you time and money.*

Labor is reduced by automating the process of attaching, detaching and pressing the film tail to the load. While the load is being wrapped, the operator remains free to attend to other tasks and stay productive. To wrap a load, the operator simply places the load on the turntable, then pulls a hanging lanyard switch. The Flex A takes care of the rest. Automation keeps your operators busy, productive and efficient.



### **Flex Low Profile Automatic Performance Features**

- 15 RPM Variable Speed with 'soft-start'
- 5,000 lb. Maximum Load Weight Capacity
- High Efficiency 260% Powered Film Pre-stretch
- 63" Diameter Turntable for Loads up to 50"x50"
- Automatic Wrap Cycle for Operator Efficiency
- Load via Forklift, Pallet Jack\* or Electric Walkie\*
- AC/VFD Motors Reduce Maintenance
- Full Surround Deck Protects Turntable
- Structural Steel Frame for Durability
- Ergonomically Friendly Design
- Forklift Portable from Front or Rear
- DuraGlide support bearings for quiet & reliable operation



### **Flex High Profile Automatic Performance Features**

- 15 RPM Variable Speed with 'soft-start'
- 5,000 lb. Maximum Load Weight Capacity
- High Efficiency 260% Powered Film Pre-stretch
- 48"x48" Turntable for Loads up to 50"x50"
- Automatic Wrap Cycle for Operator Efficiency
- Octagonal Turntable for Easy Forklift Loading
- AC/VFD Motors Reduce Maintenance
- Structural Steel Frame for Durability
- Ergonomically Friendly Design
- Precision Ring Bearing Turntable Support



*\* Optional loading ramp required. Above model shown with optional ramp*

## *Flex Machines Save you Money Every Time you Wrap a Load*

The Flex A and D Series machines use a proven powered pre-stretch technology that saves you money with every load you wrap by accurately pre-stretching the film 260%. This not only reduces your cost per load, but also brings out the maximum strength properties of the film itself, so wrapped loads stay wrapped throughout their journey.

### **State-of-the-art Controller Technology**

From its clean and simple user interface on the outside to its sophisticated programmable logic controller and AC variable frequency drives inside, every aspect of the Flex control package has been designed for maximum reliability, flexibility and ease-of-use.



### **Heavy Duty (optional) Ramp for Easy Loading via Electric Walkie or Pallet Jack**

An optional Flex loading ramp can be placed in any one of three loading positions: right, left or center. Flex LPA and LPD models feature a full surround deck around the turntable for added convenience when placing loads. Gradual turntable acceleration (soft-start) assures that light or unstable loads can be safely wrapped.



### **Orion Insta-Thread™ Film Delivery System**

Flex A and D Series machines help you reduce cost with every load you wrap. With a standard film pre-stretch rate of 260% (higher than most competitive machines) you'll not only save money by using less film, the film on the load will be stronger, so loads are securely wrapped for storage or shipping.

## *The Flex D (Deluxe) Series: Cost Effective, Rugged and Reliable.*

The Flex LPD and HPD models have been designed and built with economy, efficiency and safe operation in mind. These stretch wrapping machines will give you all of the features you need to wrap pallet loads quickly and efficiently, using the least amount of stretch film. With several available options like extended base or mast, or 30" film carriage, you can have your Flex machine built to do exactly what you need it to do.



### **Flex Low Profile Deluxe Performance Features**

- 15 RPM Variable Speed with 'soft-start'
- 5,000 lb. Maximum Load Weight Capacity
- High Efficiency 260% Powered Film Pre-stretch
- 63" Diameter Turntable for Loads up to 55"x55"
- Load via Forklift, Pallet Jack\* or Electric Walkie\*
- AC/VFD Motors Reduce Maintenance
- Full Surround Deck Protects Turntable
- Structural Steel Frame for Durability
- Ergonomically Friendly Design
- Forklift Portable from Front or Rear
- DuraGlide support bearings for quiet & reliable operation



### **Flex High Profile Deluxe Performance Features**

- 15 RPM Variable Speed with 'soft-start'
- 5,000 lb. Maximum Load Weight Capacity
- High Efficiency 260% Powered Film Pre-stretch
- 48"x48" Turntable for Loads up to 55"x55"
- Octagonal Turntable for Easy Forklift Loading
- AC/VFD Motors Reduce Maintenance
- Structural Steel Frame for Durability
- Ergonomically Friendly Design
- Forklift Portable from Front or Rear
- 8 Heavy-Duty Turntable Support Casters



*\* Optional loading ramp required. Above model shown with optional ramp*

# The Flex Series at a Glance: Features & Available Options

Flex FEATURES Chart	LPA	HPA	LPD	HPD	LPE	HPE
<b>Automation</b>						
Automatic Film Clamp/Cut	Std.	Std.	N A	N A	N A	N A
Automatic Film Press-to-Load	Std.	Std.	N A	N A	N A	N A
Automatic Load Height Detection	Std.	Std.	Std.	Std.	Option	Option
InstaCut Automatic Film Severance	N A	N A	Option	Option	N A	N A
<b>Turntable</b>	LPA	HPA	LPD	HPD	LPE	HPE
4,000 Pound Capacity	N A	N A	N A	N A	Std.	Std.
5,000 Pound Capacity	Std.	Std.	Std.	Std.	N A	N A
6,000 Pound Capacity	Option	Option	Option	Option	N A	N A
Steel Deck Frame Surrounding Turntable	Std.	N A	Std.	N A	N A	N A
4 Point Caster Support	N A	N A	N A	N A	N A	Std.
8 Point Caster Support	N A	N A	N A	Std.	N A	Option
Multiple DuraGlide Support Bearings	Std.	N A	Std.	N A	Std.	N A
Direct Chain & Sprocket Drive	Std.	Std.	Std.	Std.	Std.	Std.
<b>Film Carriage</b>	LPA	HPA	LPD	HPD	LPE	HPE
InstaThread Premium @ 260%	Std.	Std.	Std.	Std.	N A	N A
InstaThread @ 200%	N A	N A	N A	N A	Option	Option
Automatic Force-to-Load Control	Std.	Std.	Std.	Std.	Option	Option
EconoStretch Tensioning System	N A	N A	N A	N A	Std.	Std.
Drop-In Film Threading	Std.	Std.	Std.	Std.	Std.	Std.
Lifetime Warranty Stretch Rollers	Std.	Std.	Std.	Std.	N A	N A
<b>Controls &amp; Drives</b>	LPA	HPA	LPD	HPD	LPE	HPE
Telemecanique Industrial PLC	Std.	Std.	Std.	Std.	Std.	Std.
HMI Digital Display	Std.	Std.	Std.	Std.	N A	N A
Separate UP/DOWN Carriage Speeds	Std.	Std.	Std.	Std.	N A	N A
Photocell Load Height Detection	Std.	Std.	Std.	Std.	Option	Option
NEMA 12 Control Box	Std.	Std.	Std.	Std.	Std.	Std.
AC Motors	Std.	Std.	Std.	Std.	Std.	Std.
Variable Frequency Drives	Std.	Std.	Std.	Std.	Std.	Std.
<b>Structural</b>	LPA	HPA	LPD	HPD	LPE	HPE
Full Length Structural Steel Base	Std.	Std.	Std.	Std.	Std.	Std.
Forklift Portable from Front & Rear	Std.	Std.	Std.	Std.	Std.	Std.
Steel Deck Frame Surrounding Turntable	Std.	N A	Std.	N A	N A	N A
Pallet-Jack Ramp	Option	N A	Option	N A	Option	N A
Electric-Walkie or Pallet-Jack Ramp	Option	N A	Option	N A	Option	N A
<b>Safe Interaction</b>	LPA	HPA	LPD	HPD	LPE	HPE
Drop-In Film Threading	Std.	Std.	Std.	Std.	Std.	Std.
Film Carriage "Drop-Lock" Technology	Std.	Std.	Std.	Std.	Std.	Std.
Film Carriage Down Obstacle Detection	Std.	Std.	Std.	Std.	N A	N A
Steel Guarding at Film Clamp/Cut/Press	Std.	Std.	N A	N A	N A	N A

## Popular Flex Series Options

(Contact your local Orion distributor for the best configuration for your application)

- Loading Ramp
- Oversize Load Configuration
- 30" Insta-Thread™ Film Carriage
- Insta-Cut Automatic Film Web Severance
- "Stretch & Weigh" Scale Package
- Dual Turntable Option
- Extra Heavy Load Weight Capacity
- Environmental Options

## Flex Series Dimensions

### Flex LP Models

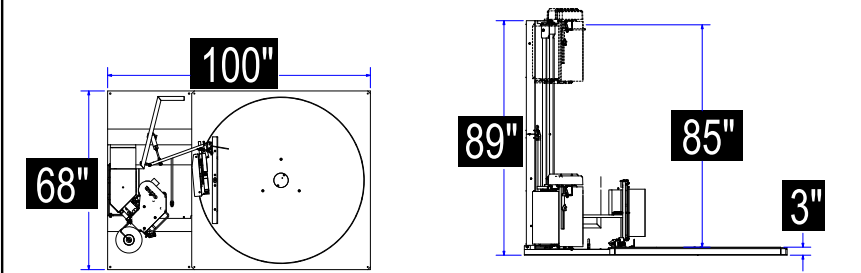

### Flex HP Models

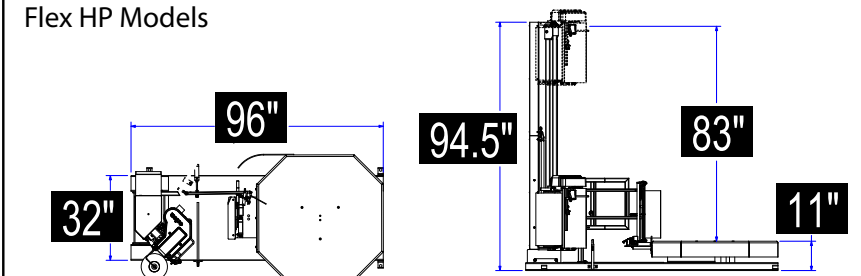

## The Flex E (Economy) Series: Low Cost Doesn't Mean Low Quality.

Want to eliminate inconsistent and labor intensive manual hand-wrapping of pallet loads in lower volume applications? The Flex E Series is the solution. Although Flex E machines are designed for less demanding applications, they share many of the same structural and basic features as D and A models.



An *optional* 200% powered film pre-stretch for reduced film usage.



The E Series control panel features industrial grade buttons & switches.



The standard E Series film tensioning system features easy threading.

### Flex Low Profile Economy Performance Features

- 12 RPM Variable Speed with 'soft-start'
- 4,000 lb. Maximum Load Weight Capacity
- Adjustable Film Tension Carriage
- Optional 200% Powered Film Pre-stretch
- 63" Diameter Turntable for Loads up to 55"x55"
- Load via Forklift, Pallet Jack\* or Electric Walkie\*
- AC/VFD Motors Reduce Maintenance
- Structural Steel Frame for Durability
- Ergonomically Friendly Design
- Forklift Portable from Front or Rear
- DuraGlide support bearings for quiet & reliable operation

### Flex High Profile Economy Performance Features

- 12 RPM Variable Speed with 'soft-start'
- 4,000 lb. Maximum Load Weight Capacity
- Adjustable Film Tension Carriage
- Optional 200% Powered Film Pre-stretch
- 48"x48" Turntable for Loads up to 55"x55"
- Octagonal Turntable for Easy Forklift Loading
- AC/VFD Motors Reduce Maintenance
- Structural Steel Frame for Durability
- Ergonomically Friendly Design
- Forklift Portable from Front or Rear
- 4 Heavy-Duty Turntable Support Casters



\* Optional loading ramp required. Above model shown with optional ramp and Insta-Thread LT™ film delivery system



**FLEX**  
SERIES  
HPD

**ORION**

**FLEX** orion  
SERIES HPD

  
**orion**<sup>®</sup>  
Stretch Packaging Systems

Orion Packaging Systems, Inc.  
A Division of Pro Mach, Inc.  
100 Crescent Drive  
Collierville, TN 38017  
Toll Free (800) 333-6556  
Telephone (901) 888-4170  
Fax (901) 365-1071  
Email: [sales@orionpackaging.com](mailto:sales@orionpackaging.com)  
Web: [www.orionpackaging.com](http://www.orionpackaging.com)  
Bulletin #FLEX\_06/08.CC

  
Proudly Made in the U.S.A.

All dimensions approximate. Orion Packaging Systems reserves the right to change specifications without notice.